

ACCESS 165 AS

Woofer (6^{1/2}"



- Cone DFS®
- ABS basket

SPECIFICATIONS

Nominal power	60W	
Maximum power	120W	
Sensitivity (2,83V/1m)	91dB	
Cone	Glass fiber	
Surround	Butyl	
Nom. impedance	4 Ohms	
DC resistance	3.5 Ohms	
VC diameter	25mm	1"
VC height	10mm	0 ^{3/8} "
Former	Kapton	
Layers	2	
Wire	Copper	
Inductance	-	
Xmax	± 2.5mm	0 ^{1/8} "
Magnet d x h	85mm x 15mm	3 ^{1/3} x 0 ^{9/16} "
Magnet weight	380g	0.76 lbs
Flux density	1T	
Gap height	5mm	0 ^{3/16} "
Net weight	0.85kg	1.70 lbs

FREQUENCY RESPONSE/IMPEDANCE

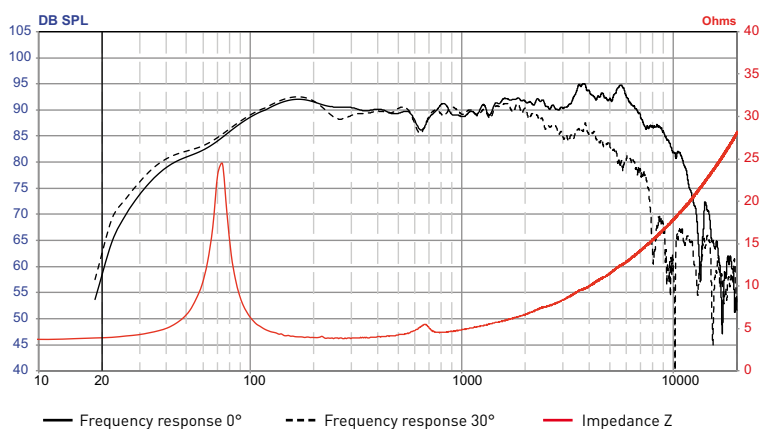

PARAMETERS

Fs	73.8Hz
Vas	8.9 liters
Qts	0.905
Qes	1.03
Qms	7.43
Re	3.54 Ohms
Sd	136.85cm ²
Cas	6,32E-08 m5/N
Mas	73,37 Kg/m4
Ras	4578,87 Ohms.ac
Cms	3380µm/N
Mms	13.74g
Rms	0.858kg/s
Ces	627.48mF
Les	7.48mH
Res	25.54 Ohms
BI	4.68N/A
SPL	87.25 dB/W/m

MECHANICAL DRAWING

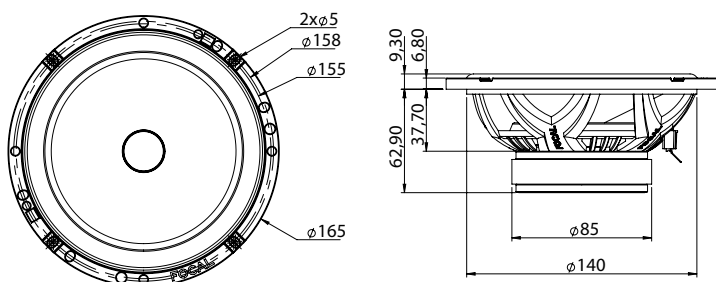

Performance
CREATE YOUR SOUND

FOCAL
THE SPIRIT OF SOUND